



3A. SMS. DIN. BS. AS

Tube Line, Elbow / Tee / Reducer

Tube fittings can use for sanitary, pharmaceutical, vacuum...etc.



it can be equipped with different types or connector ends, as 45° /90° elbow, tee, concentric/ eccentric reducer///weld, clamp, unions...
Standard type: 3A, SMS, DIN, BS, BPE...etc.
Material: ASTM 304, 316, 316L
Surface: 1) ID/OD polishing.
2) Only ID polishing.
3) Only OD polishing.
4) unpolished.
Roughness: #400, #320, #240, #180...
Ra ≤ 0.8um, 0.6um, 0.5um, 0.4um...
(Other surface finish can be ordered).

Sanitary Tubes For Biochemistry, Pharmaceutical, Food...etc.



BPE standard			SMS standard			IDF standard			3A sanitary standard			DIN 11850		
SIZE	O.D	T	SIZE	O.D	T	SIZE	O.D	T	SIZE	O.D	T	SIZE	O.D	T
1/2"	12.7	1.65												
1.0"	25.4	6.65	25	25	1.25	1.0"	25.4	1.2	25.4	1.65	25	28	28	1
			32	32	1.25	1.25"	31.8	1.2				32	34	1
														1.5
1.5"	38.1	1.65	38	38	1.25	1.5"	38.1	1.2	38.1	1.65	40	40	40	1
														1.5
2.0"	50.8	1.65	51	51	1.25	2.0"	50.8	1.5	50.8	1.65	50	52	52	1
														1.5
2.5"	63.5	1.65	63.5	63.5	1.5	2.5"	63.5	2	63.5	1.65	65	70	70	2
3.0"	76.2	1.65	76	76.1	1.6	3.0"	76.3	2	76.2	1.65	80	85	85	2
4.0"	101.6	2.11	104	104	2	4.0"	101.6	2	101.6	1.65	100	104	104	2
										2.11				

Sanitary for food, and pharmaceutical industry

Material: ASTM 304, 304L, 316L

Spec: ASTM A267, A270.

Surface & Roubhness:

1. OD/ID pichle (Ra ≤ 1.0um)

2. polished:

(1) ID polished to 180Grit (Ra ≤ 0.8um).

(2) ID polished to 240Grit (Ra ≤ 0.6um).

(3) ID polished to 320Grit (Ra ≤ 0.5um).

(4) ID polished to 420Grit (Ra ≤ 0.4um).

(5) Electro polished:

(5-1). ID Electro polished Ra ≤ 0.5um).

(5-2). ID Electro polished Ra ≤ 0.38um).

45° short elbow

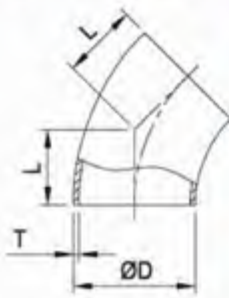

45° 短弯头
C.2 wk-45° elbow

SIZE	ΦD	L	T
1/2"	12.7	13.16	1.65
3/4"	19.05	23.8	1.65
1.0"	25.4	15.8	1.65
1.5"	38.1	23.8	1.65
2.0"	50.8	31.75	1.65
2.5"	63.5	39.6	1.65
3.0"	76.2	47.6	1.65
4.0"	101.6	63.5	2.10
6.0"	152.4	95.25	2.77

45° long elbow

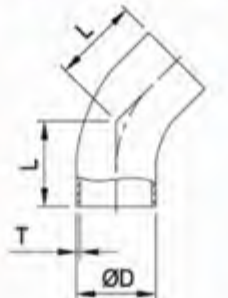

45° 长弯头
C.L2ks-45° elbow

SIZE	ΦD	L	T
1/2"	12.7	30.2	1.65
3/4"	19.05	30.0	1.65
1.0"	25.4	30.2	1.65
1.5"	38.1	41.3	1.65
2.0"	50.8	58.7	1.65
2.5"	63.5	76.2	1.65
3.0"	76.2	93.7	1.65
4.0"	101.6	122.2	2.10
6.0"	152.4	158.2	2.80

90° short bend

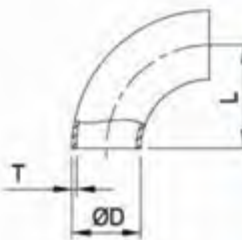

90° 长弯头
C.2 WCL-90° bend

SIZE	ΦD	L	T
1.65	1/2"	19.05	12.7
1.65	3/4"	28.58	19.05
1.65	1.0"	38.1	25.4
1.65	1.5"	57.2	38.1
1.65	2.0"	76.2	50.8
1.65	2.5"	95.25	63.5
1.65	3.0"	114.3	76.2
2.10	4.0"	152.4	101.6
2.77	6.0"	228.6	152.4

90° long bend

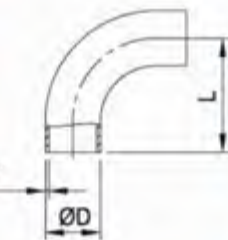

90° 长弯头
C.L2S-90° bend

SIZE	ΦD	L	T
1/2"	12.7	45	1.65
3/4"	19.05	60	1.65
1.0"	25.4	52.4	1.65
1.5"	38.1	74.6	1.65
2.0"	50.8	103.2	1.65
2.5"	63.5	131.8	1.65
3.0"	76.2	160.3	1.65
4.0"	101.6	211.1	2.10
6.0"	152.4	292.1	2.80

Welding Tee

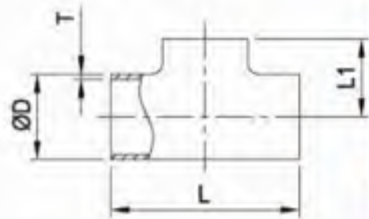

C.L7WWW-Short Tee 短三通

SIZE	ΦD	ΦL	L1	T
1/2"	12.7	38.1	19.05	1.65
3/4"	19.05	57.2	28.6	1.65
1.0"	25.4	57.2	28.6	1.65
1.5"	38.1	84.2	42.1	1.65
2.0"	50.8	104.8	52.4	1.65
2.5"	63.5	119.0	59.5	1.65
3.0"	76.2	131.8	65.9	1.65
4.0"	101.6	174.6	87.3	2.10

C.L7W-Long Tee 长三通

SIZE	ΦD	ΦL	L1	T
1/2"	12.7	95.2	47.6	1.65
3/4"	19.05	95.2	47.6	1.65
1.0"	25.4	95.2	47.6	1.65
1.5"	38.1	114.4	57.2	1.65
2.0"	50.8	152.4	76.2	1.65
2.5"	63.5	152.4	76.2	1.65
3.0"	76.2	165.2	82.6	1.65
4.0"	101.6	196.8	98.4	2.10
6.0"	152.4	285.8	142.9	2.77

变径短三通

C.L7RW-short Reducing Tee

SIZE	ΦD	ΦD	L	L1	T
1.5"x1.0"	38.1	25.4	84.2	34.9	1.65
2.0"x1.0"	50.8	25.4	104.8	41.3	1.65
2.0"x1.5"	50.8	38.1	104.8	48.4	1.65
2.5"x1.0"	63.5	25.4	119	47.63	1.65
2.5"x1.5"	63.5	38.1	119	54.75	1.65
2.5"x2.0"	63.5	50.8	119	58.7	1.65
3.0"x1.0"	76.2	25.4	131.8	54.0	1.65
3.0"x1.5"	76.2	38.1	131.8	65.1	1.65
3.0"x2.0"	76.2	50.8	131.8	65.1	1.65
3.0"x2.5"	76.2	63.5	131.8	65.9	1.65
4.0"x1.0"	101.6	25.1	174.6	66.7	2.1
4.0"x1.5"	101.6	38.1	174.6	108.0	2.1
4.0"x2.0"	101.6	50.8	174.6	108.0	2.1
4.0"x2.5"	101.6	63.5	174.6	108.0	2.1
4.0"x3.0"	101.6	76.2	174.6	108.0	2.1

变径长三通

C.L7RW-Long Reducing Tee

SIZE	ΦD	Φd	L	L1	T
1.5"x1.0"	38.1	25.4	114.3	54	1.65
2.0"x1.0"	50.8	25.4	152.4	60.30	1.65
2.0"x1.5"	50.8	38.1	152.4	63.50	1.65
2.5"x1.5"	63.5	38.1	152.4	69.85	1.65
2.5"x2.0"	63.5	50.8	152.4	82.55	1.65
3.0"x1.5"	76.2	38.1	165.1	76.20	1.65
3.0"x2.0"	76.2	50.8	165.1	88.9	1.65
3.0"x2.5"	76.2	63.5	165.1	82.55	1.65
4.0"x2.0"	101.6	50.8	196.8	101.6	2.10
4.0"x2.5"	101.6	63.5	196.8	95.25	2.10
4.0"x3.0"	101.6	76.2	196.8	95.25	2.10

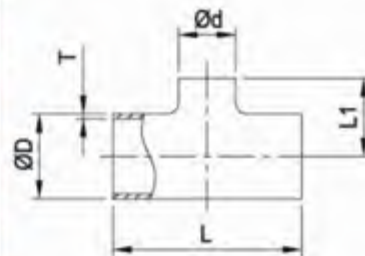

Cross

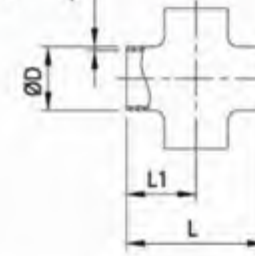

短四通

C.L9WWW-Short Cross

SIZE	ΦD	L	L1	T
1.0"	25.4	57.2	28.6	1.65
1.5"	38.1	84.2	42.1	1.65
2.0"	50.8	104.8	52.4	1.65
2.5"	63.5	119.0	59.5	1.65
3.0"	76.2	131.8	65.9	1.65
4.0"	101.6	174.6	87.3	2.10

长四通

C.L9W-Long Cross

SIZE	ΦD	L	L1	T
1.0"	25.4	95.2	47.6	1.65
1.5"	38.1	114.4	57.2	1.65
2.0"	50.8	152.4	76.2	1.65
2.5"	63.5	152.4	76.2	1.65
3.0"	76.2	165.2	82.6	1.65
4.0"	101.6	196.8	98.4	2.10

Concentric Reducer



同心大小头

C.L31-Concentric Reducer

SIZE	ΦD	Φd	L	T
3/4"x1/2"	19.05	12.7	50.8	1.65
1.0"x1/2"	25.4	12.7	50.8	1.65
1.5"x1/2"	38.1	12.7	101.6	1.65
2.0"x1/2"	50.8	12.7	152.4	1.65
1.0"x3/4"	25.4	19.05	25.4	1.65
1.5"x3/4"	38.1	19.05	76.2	1.65
1.5"x1.0"	38.1	25.4	50.8	1.65
2.0"x1.0"	50.8	25.4	101.6	1.65
2.0"x1.5"	50.8	38.1	50.8	1.65
2.5"x1.0"	63.5	25.4	152.4	1.65
2.5"x1.5"	63.5	38.1	101.6	1.65
2.5"x2.0"	63.5	50.8	50.8	1.65

SIZE	ΦD	Φd	L	T
3.0"x1.0"	76.2	25.4	203.2	1.65
3.0"x1.5"	76.2	38.1	152.4	1.65
3.0"x2.0"	76.2	50.8	101.6	1.65
3.0"x2.5"	76.2	63.5	50.8	1.65
4.0"x1.5"	101.6	38.1	254	2.10
4.0"x2.0"	101.6	50.8	203.2	2.10
4.0"x2.5"	101.6	63.5	152.4	2.10
4.0"x3.0"	101.6	76.2	101.6	2.10
6.0"x2.0"	152.4	50.8	406.4	2.77
6.0"x3.0"	152.4	76.2	304.8	2.77
6.0"x4.0"	152.4	101.6	203.2	2.77

Eccentric Reducer

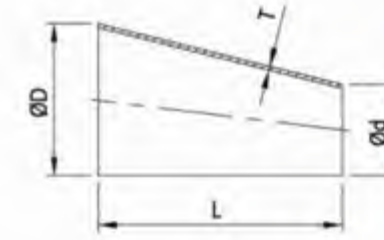

偏心大小头

C.L32-Eccentric Reducer

SIZE	ΦD	Φd	L	T
3/4"x1/2"	19.05	12.7	25.4	1.65
1.0"x1/2"	25.4	12.7	50.8	1.65
1.5"x1/2"	38.1	12.7	101.6	1.65
2.0"x1/2"	50.8	12.7	152.4	1.65
1.0"x3/4"	25.4	19.05	25.4	1.65
1.5"x3/4"	38.1	19.05	76.2	1.65
2.0"x3/4"	50.8	19.05	127	1.65
1.5"x1.0"	38.1	25.4	50.8	1.65
2.0"x1.0"	50.8	25.4	101.6	1.65
2.0"x1.5"	50.8	38.1	50.8	1.65
2.5"x1.0"	63.5	25.4	152.4	1.65
2.5"x1.5"	63.5	38.1	101.6	1.65

SIZE	ΦD	Φd	L	T
2.5"x2.0"	63.5	50.8	50.8	1.65
3.0"x1.0"	76.2	25.4	203.2	1.65
3.0"x1.5"	76.2	38.1	152.4	1.65
3.0"x2.0"	76.2	50.8	101.6	1.65
3.0"x2.5"	76.2	63.5	50.8	1.65
4.0"x1.5"	101.6	38.1	254	2.10
4.0"x2.0"	101.6	50.8	203.2	2.10
4.0"x2.5"	101.6	63.5	152.4	2.10
4.0"x3.0"	101.6	76.2	101.6	2.10
6.0"x2.0"	152.4	50.8	406.4	2.77
6.0"x3.0"	152.4	76.2	304.8	2.77
6.0"x4.0"	152.4	101.6	203.2	2.77

45° Clamp Elbow

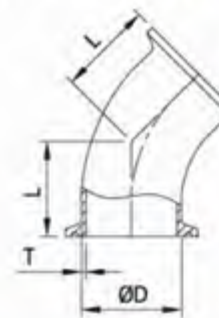

45短夹弯头

C.2KMP-45° Elbow

SIZE	ΦD	L	T
1.0"	25.4	28.5	1.65
1.5"	38.1	36.5	1.65
2.0"	50.8	44.45	1.65
2.5"	63.5	52.3	1.65
3.0"	76.2	60.3	1.65
4.0"	101.6	76.2	2.1

90° Clamp Bend

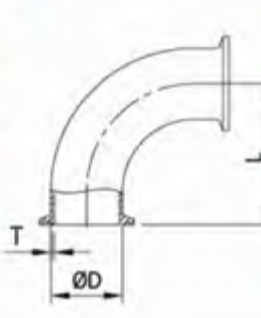

90夹式弯头

C.2CMP-90° Bend

SIZE	ΦD	L	T
1/2"	12.7	41.3	1.65
3/4"	19.05	41.3	1.65
1.0"	25.4	50.8	1.65
1.5"	38.1	69.9	1.65
2.0"	50.8	88.9	1.65
2.5"	63.5	107.95	1.65
3.0"	76.2	127	1.65
4.0"	101.6	168.2	2.1

Clamp Tee

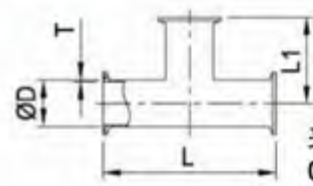

夹式三通
C.7MP-Clamp Long Tee

SIZE	φD	L	L1	T
1/2"	12.7	63.5	31.75	1.65
3/4"	19.05	120.6	60.3	1.65
1.0"	25.4	120.6	60.3	1.65
1.5"	38.1	139.8	69.9	1.65
2.0"	50.8	177.8	88.9	1.65
2.5"	63.5	177.8	88.9	1.65
3.0"	76.2	190.6	95.3	1.65
4.0"	101.6	228.4	114.2	2.10

Reducing Tee

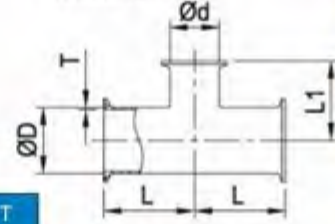

夹式变径长三通

C.L7RMP-Reducing Long Tee Clamp End

SIZE	φD	φd	L	L1
1.5"x1.0"	38.1	25.4	69.85	66.68
2.0"x1.0"	50.8	25.4	88.9	73.0
2.0"x1.5"	50.8	38.1	88.9	76.2
2.5"x1.5"	63.5	38.1	88.9	82.55
2.5"x2.0"	63.5	50.8	88.9	95.25
3.0"x1.5"	76.2	38.1	95.25	88.9
3.0"x2.0"	76.2	50.8	95.25	101.6
3.0"x2.5"	76.2	63.5	95.25	95.25
4.0"x2.0"	101.6	50.8	114.2	114.3
4.0"x2.5"	101.6	63.5	114.2	107.95
4.0"x3.0"	101.6	76.2	114.2	107.95

Equal Tee

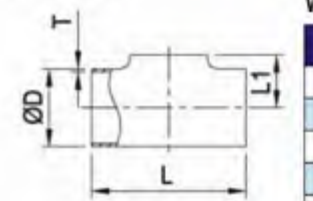

等径平口三通
C.7WW Equal Tee
W/O Straight end

SIZE	φD	L	L1	T
1.0"	25.4	57.2	16	1.65
1.5"	38.1	84.2	22	1.65
2.0"	50.8	104.8	29	1.65
2.5"	63.5	119.0	35	1.65
3.0"	76.2	131.8	41	1.65
4.0"	101.6	174.6	54	2.10

Reducing Tee

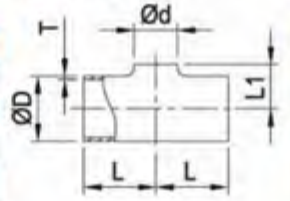

变径平口三通
C.7RWW W/O Straight end
Reducing Tee

SIZE	φD	D	L	L1
1.5"x1.0"	38.1	25.4	42.1	22
2.0"x1.5"	50.8	38.1	52.4	29
2.5"x2.0"	63.5	50.8	59.5	35
3.0"x2.0"	76.2	50.8	65.9	41
3.0"x2.5"	76.2	63.5	65.9	41
4.0"x2.0"	101.6	50.8	117.5	54
4.0"x2.5"	101.6	63.5	117.5	54
4.0"x3.0"	101.6	76.2	117.5	54

夹式偏心/同心大小头
C.32-14MP Eccentric Reducer Clamp End
C.31-14MP Conccentric Reducer Clamp End

SIZE	φD	φd	L
1.5"x1.0"	38.1	25.4	76.2
2.0"x1.5"	50.8	38.1	76.2
2.5"x1.5"	63.5	38.1	127
2.5"x2.0"	63.5	50.8	76.2
3.0"x1.5"	76.2	38.1	177.8
3.0"x2.0"	76.2	50.8	127
3.0"x2.5"	76.2	63.5	76.2
4.0"x1.5"	101.6	38.1	282.5
4.0"x2.0"	101.6	50.8	231.7
4.0"x2.5"	101.6	63.5	180.9
4.0"x3.0"	101.6	76.2	130.1

Concentric Reducer

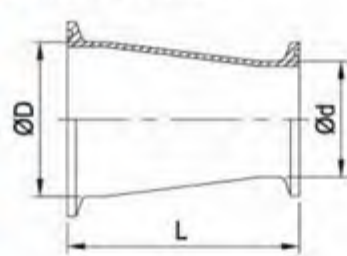

Eccentric Reducer

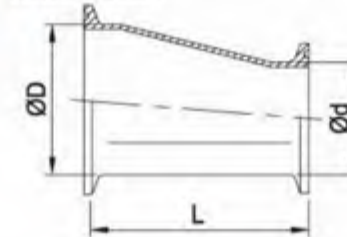

Clamp Cross

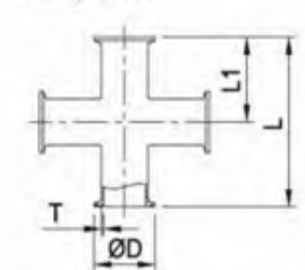

夹式长四通
C.9MP-Clamp Long Cross

SIZE	φD	L	L1	T
1.0"	25.4	120.6	60.3	1.65
1.5"	38.1	139.8	69.9	1.65
2.0"	50.8	177.8	88.9	1.65
2.5"	63.5	177.8	88.9	1.65
3.0"	76.2	190.6	95.3	1.65
4.0"	101.6	228.4	114.2	2.10

90° Short Elbow

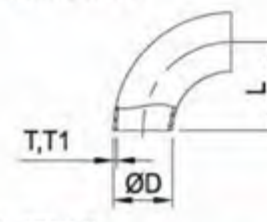

90° 短弯头
SMS 90 B 90° Short Elbow

DN	φD	L	T	T1
25	25.4	37.5	1.25	1.5
38	38.0	57.0	1.25	1.5
51	51.0	76.5	1.25	1.5
63.5	63.5	95.25	1.5	1.5
76	76.1	114.15	1.6	2.0
104	104	152.1	2.0	2.0

SMS ET 等径三通
SMS ET Tee With Straight-End

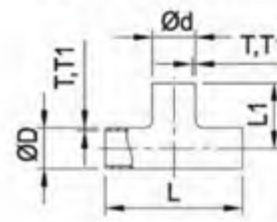

SMS PT 等径平口三通
SMS PT Tee Without Straight-End

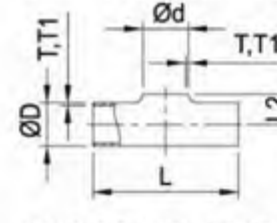

SMS PC 等径平口四通
SMS PC
Welding Cross Without Straight-End

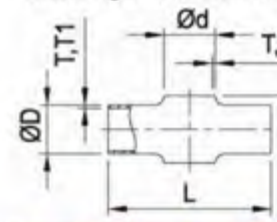

DN	φD	φd	T	T1	L	L1	L2
25	25.0	25	1.25	1.5	110	55	14.0
38	38.0	38.0	1.25	1.5	140	70	21.0
51	51.0	51.0	1.25	1.5	164	82	28.5
63.5	63.5	63.5	1.5	1.5	210	105	36.0
76.1	76.1	76.1	1.6	2.0	220	110	43.0
104	104	104	2.0	2.0	300	150	58.0

45° Long Elbow



45长弯头
SMS 45 LB 45° Long Elbow

DN	φD	L	T	T1
25	25.4	42.33	1.25	1.5
38	38.0	48.72	1.25	1.5
51	51.0	58.15	1.25	1.5
63.5	63.5	75.3	1.5	1.5
76	76.1	79.37	1.6	2.0
104	104	85.54	2.0	2.0

SMS CR 同心大小头
SMS CR SMS Concentric Reducer

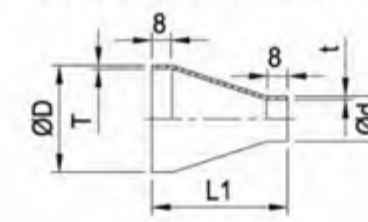

SMS ER 偏心大小头
SMS ER SMS Eccentric Reducer

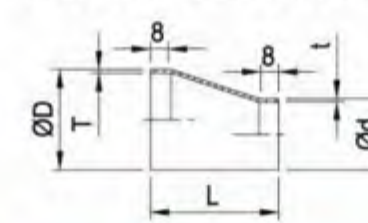

90° Long Elbow

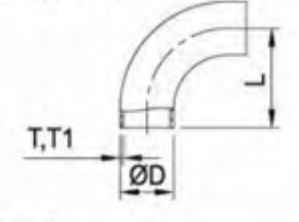

90长弯头
SMS 90 LB 90° Long Elbow

DN	φD	L	T	T1
25	25.4	55	1.25	1.5
38	38.0	70	1.25	1.5
51	51.0	82	1.25	1.5
63.5	63.5	105	1.5	1.5
76	76.1	110	1.6	2.0
101.6	101.6	150	2.0	2.0
104	104	150	2.0	2.0

SMS PRT 变径平口三通
SMS PRT
Welding Reducing Tee
Without Straight-End

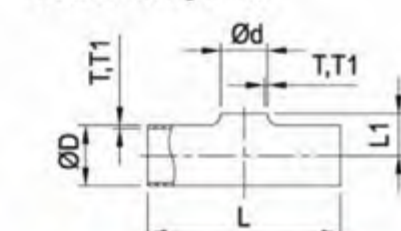

DN	φD	φd	T	T1	L	L1
38x25	38	25	1.25	1.5	140	21
51x25	51	25	1.25	1.5	164	29
51x38	51	38	1.25	1.5	164	29
63.5x25	63.5	25	1.5	1.5	210	34.5
63.5x38	63.5	38	1.5	1.5	210	35
63.5x51	63.5	51	1.5	1.5	210	36
76.1x25	76.1	25	1.6	2.0	220	41
76.1x38	76.1	38	1.6	2.0	220	42
76.1x51	76.1	51	1.6	2.0	220	43
76.1x63.5	76.1	63.5	1.6	2.0	220	43
104x25	104	25	2.0	2.0	300	56
104x38	104	38	2.0	2.0	300	56
104x51	104	51	2.0	2.0	300	57
104x63.5	104	63.5	2.0	2.0	300	58
104x76.1	104	76.1	2.0	2.0	300	58

DIN 45° Long Elbow

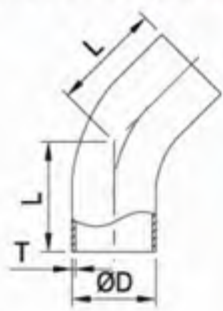

45° 长弯头
DIN 45 LB

SIZE	φD	L	T
DN25	28	20	1.5
DN32	34	23	1.5
DN40	40	20	1.5
DN50	52	27	1.5
DN65	70	30	2.0
DN80	85	33	2.0
DN100	104	40	2.0



45° Long Elbow

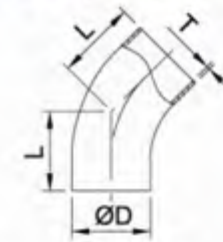

BS 45 LB 45° 长弯头

SIZE	φD	L	T
1.0"	25.4	30.2	1.65
1.5"	38.1	41.3	1.65
2.0"	50.8	58.7	1.65
2.5"	63.5	76.2	1.65
3.0"	76.2	93.7	1.65
4.0"	101.6	122.2	2.10

90° Short Tube Bend

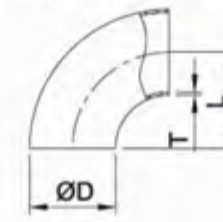

BS 90 B 90° 短弯头

SIZE	φD	L	T
1.0"	25.4	43.5	1.65
1.5"	38.1	63.5	1.65
2.0"	50.8	88.5	1.65
2.5"	63.5	113.5	1.65
3.0"	76.2	133.5	1.65
4.0"	101.6	173.5	2.10

DIN 90° Short Bend

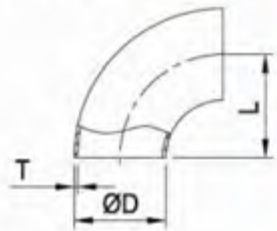

90° 短弯头
DIN 90 B

SIZE	φD	L	T
DN20	22	40	1.5
DN25	28	50	1.5
DN32	34	55	1.5
DN40	40	60	1.5
DN50	52	70	1.5
DN65	70	80	2.0
DN80	85	190	2.0
DN100	101.6	152.4	2.0
DN100	104	100	2.0

DIN 90° Long Bend

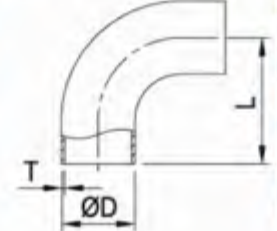

90° 长弯头
DIN 90 LB

SIZE	φD	L	T
DN25	28	70	1.5
DN32	34	78	1.5
DN40	40	85	1.5
DN50	52	97	1.5
DN65	70	110	2.0
DN80	85	118	2.0
DN100	101.6	150	2.0
DN100	104	140	2.0

90° Long Tube Bend

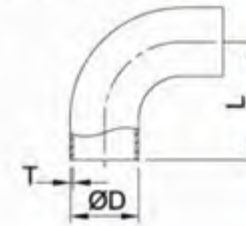

BS 90 LB 90° 长弯头

SIZE	φD	L	T
1/2"	12.7	45	1.65
3/4"	19.05	60	1.65
1.0"	25.4	65	1.65
1.5"	38.1	85	1.65
2.0"	50.8	110	1.65
2.5"	63.5	135	1.65
3.0"	76.2	155	1.65
4.0"	101.6	195	2.10

Cross

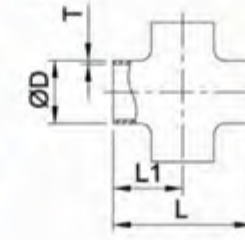

BSEC 四通

SIZE	φD	L	T1	T
1.0"	25.4	130	65	1.65
1.5"	38.1	170	85	1.65
2.0"	50.8	220	110	1.65
2.5"	63.5	270	135	1.65
3.0"	76.2	310	155	1.65
4.0"	101.6	390	195	2.10

DIN Tee & Pull Tee

DIN ET 等径三通

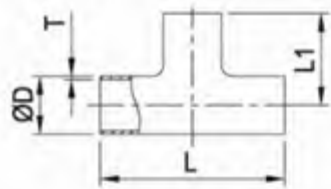

DIN PT 等径平口三通

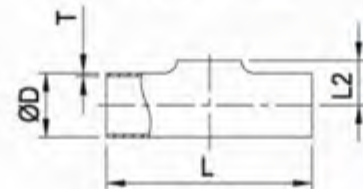

DN	φD	L	L1	L2	T
DN20	22	94	47	13	1.5
DN25	28	100	50	15.5	1.5
DN32	34	110	55	19	1.5
DN40	40	120	60	22	1.5
DN50	52	140	70	28.5	1.5
DN65	70	160	80	39.5	2.0
DN80	85	180	90	46.5	2.0
DN100	101.6	300	150	56	2.0
DN100	104	200	100	58	2.0

BS PRT 变径平口三通

SIZE	φD	φd	L	L1	T
1.5x1.0"	38.1	25.4	127	22	1.65
2.0x1.0"	50.8	25.4	177	29	1.65
2.0x1.5"	50.8	38.1	177	29	1.65
2.5x1.0"	63.5	25.4	227	35	1.65
2.5x1.5"	63.5	38.1	227	35	1.65
2.5x2.0"	63.5	50.8	227	35	1.65
3.0x1.0"	76.2	25.4	267	41	1.65
3.0x1.5"	76.2	38.1	267	41	1.65
3.0x2.0"	76.2	50.8	267	41	1.65
3.0x2.5"	76.2	63.5	267	41	1.65
4.0x2.0"	101.6	50.8	347	55	2.10
4.0x2.5"	101.6	63.5	347	55	2.10
4.0x3.0"	101.6	76.2	347	55	2.10

Reducing Tee W/O Straight End

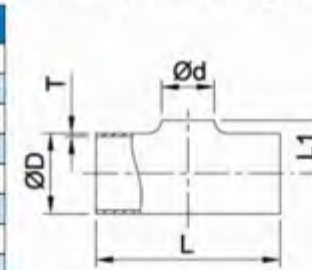

Pull Tee

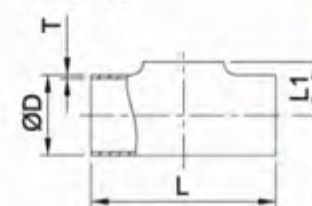

BS PT 等径平口三通

SIZE	φD	L	T1	T
1.0"	25.4	87	13.8	1.65
1.5"	38.1	127	19.9	1.65
2.0"	50.8	177	27.6	1.65
2.5"	63.5	227	34.9	1.65
3.0"	76.2	267	40.9	1.65
4.0"	101.6	347	54.7	2.10

DIN Concentric Reducer

DIN CR 同心大小头

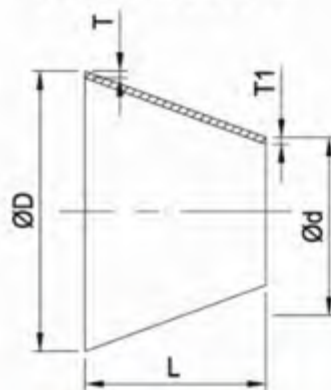

DIN ER 偏心大小头

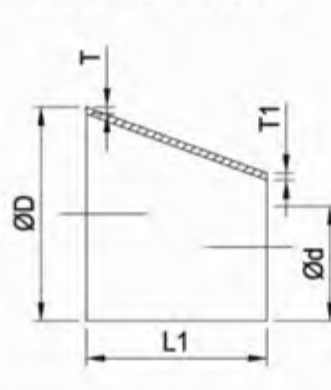

SIZE	φD	φd	T	L	L1	T1
32x25	34	28	1.5	25	16.5	1.5
40x25	40	28	1.5	23	33	1.5
40x32	40	34	1.5	23	16.5	1.5
50x25	52	28	1.5	27	66	1.5
50x32	52	34	1.5	28	49.5	1.5
50x40	52	40	1.5	27	33	1.5
65x25	70	28	1.5	35	75	1.5
65x40	70	40	2.0	39	77	1.5
65x50	70	52	2.0	29	44	1.5
80x50	85	52	2.0	45	85	1.5
80x65	85	70	2.0	33	41.2	2.0
100x50	104	52	2.0	50	137.5	1.5
100x65	104	70	2.0	44	93.5	2.0
100x80	104	85	2.0	60	52.5	2.0

Welding Tee

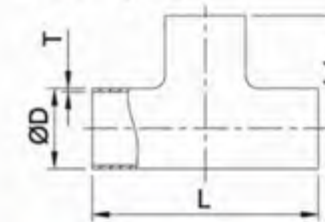

短三通

BS ETS Welding Tee

SIZE	φD	L	T1	T
1.0"	25.4	87	43.5	1.65
1.5"	38.1	127	63.5	1.65
2.0"	50.8	177	88.5	1.65
2.5"	63.5	227	113.5	1.65
3.0"	76.2	267	133.5	1.65
4.0"	101.6	347	173.5	2.10

长三通

BS ETL Long Tee

SIZE	φD	L	T1	T
1.0"	25.4	130	65	1.65
1.5"	38.1	170	85	1.65
2.0"	50.8	220	110	1.65
2.5"	63.5	270	135	1.65
3.0"	76.2	310	155	1.65
4.0"	101.6	390	195	2.10

Concentric Reducer

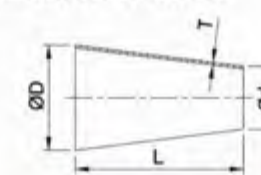

Eccentric Reducer



同心大小头
BS CR

SIZE	φD	d	L	T
1.5x1.0"	38.1	25.4	29	1.65
2.0x1.0"	50.8	25.4	53	1.65
2.0x1.5"	50.8	38.1	41	1.65
2.5x1.0"	63.5	25.4	82	1.65
2.5x1.5"	63.5	38.1	64	1.65
2.5x2.0"	63.5	50.8	40	1.65
3.0x1.0"	76.2	25.4	110	1.65
3.0x1.5"	76.2	38.1	81	1.65
3.0x2.0"	76.2	50.8	55	1.65
3.0x2.5"	76.2	63.5	41	1.65
4.0x1.5"	101.6	38.1	135	2.10
4.0x2.0"	101.6	50.8	106	2.10
4.0x2.5"	101.6	63.5	76	2.10
4.0x3.0"	101.6	76.2	53	2.10

偏心大小头
BS ER

SIZE	φD	d	L	T
1.5x1.0"	38.1	25.4	35	1.65
2.0x1.0"	50.8	25.4	54	1.65
2.0x1.5"	50.8	38.1	36	1.65
2.5x1.0"	63.5	25.4	76	1.65
2.5x1.5"	63.5	38.1	66	1.65
2.5x2.0"	63.5	50.8	35	1.65
3.0x1.0"	76.2	25.4	112	1.65
3.0x1.5"	76.2	38.1	78	1.65
3.0x2.0"	76.2	50.8	66	1.65
3.0x2.5"	76.2	63.5	44	1.65
4.0x1.5"	101.6	38.1	122	2.10
4.0x2.0"	101.6	50.8	97	2.10
4.0x2.5"	101.6	63.5	73	2.10
4.0x3.0"	101.6	76.2	77	2.10



45° Long Elbow

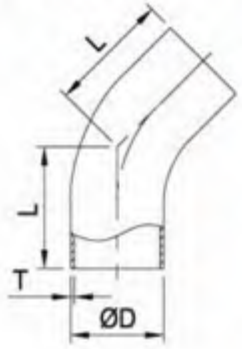

AS 45 LB 45° 长弯头

SIZE	φD	L	T
1/2"	12.7	30	1.6
3/4"	19.1	30	1.6
1.0"	25.4	30	1.6
1 1/4"	31.8	30	1.6
1.5"	38.1	30	1.6
2.0"	50.8	30	1.6
2.5"	63.5	30	1.6
3.0"	76.2	30	1.6
4.0"	101.6	30	2.0

90° Long Bend

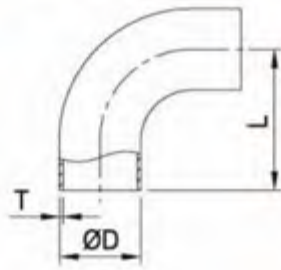

AS 90 LB 90° 长弯头

SIZE	φD	L	T
1/2"	12.7	49.1	1.6
3/4"	19.1	58.6	1.6
1.0"	25.4	68.1	1.6
1 1/4"	31.8	77.7	1.6
1.5"	38.1	87.0	1.6
2.0"	50.8	106.2	1.6
2.5"	63.5	125.0	1.6
3.0"	76.2	144.2	1.6
4.0"	101.6	182.4	2.0

90° Short Bend

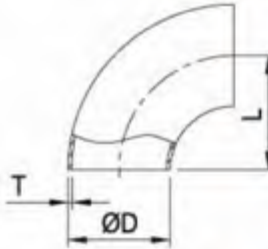

AS 90 B 90° 短弯头

SIZE	φD	L	T
1/2"	12.7	19.1	1.6
3/4"	19.1	28.6	1.6
1.0"	25.4	38.1	1.6
1 1/4"	31.8	47.7	1.6
1.5"	38.1	57.0	1.6
2.0"	50.8	76.2	1.6
2.5"	63.5	95.0	1.6
3.0"	76.2	114.2	1.6
4.0"	101.6	152.4	2.0

Long Tee

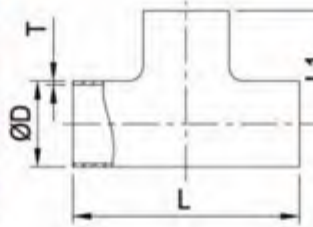

AS ET 长三通

SIZE	φD	L	L1	T
1/2"	12.7	98.2	49.1	1.6
3/4"	19.1	117.2	58.6	1.6
1.0"	25.4	136.2	68.1	1.6
1 1/4"	31.8	155.4	77.7	1.6
1.5"	38.1	174.0	87.0	1.6
2.0"	50.8	212.4	106.2	1.6
2.5"	63.5	250.0	125.0	1.6
3.0"	76.2	288.4	144.2	1.6
4.0"	101.6	364.8	182.4	2.0

Short Tee/Equal Tee

AS ET 短三通

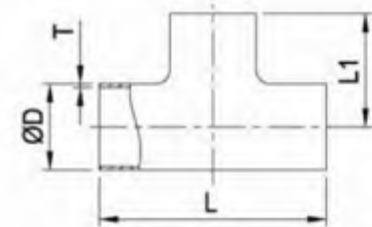

AS PT 平口三通

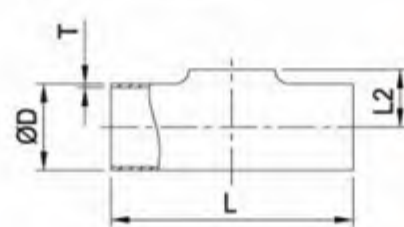

AS ET

SIZE	φD	L	L1	L2	T
1/2"	12.7	38.2	19.1	9.35	1.6
3/4"	19.1	57.2	28.6	12.55	1.6
1.0"	25.4	76.2	38.1	15.7	1.6
1 1/4"	31.8	95.4	47.7	18.9	1.6
1.5"	38.1	114.0	57.0	22.05	1.6
2.0"	50.8	152.4	76.2	28.4	1.6
2.5"	63.5	190.0	95.0	34.75	1.6
3.0"	76.2	228.4	114.2	41.1	1.6
4.0"	101.6	304.8	152.4	53.8	2.0

AS EC Long Cross

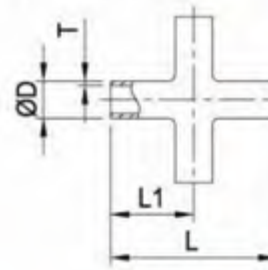

长四通

SIZE	φD	L	L1	T
1/2"	12.7	98.2	49.1	1.6
3/4"	19.1	117.2	58.6	1.6
1.0"	25.4	136.2	68.1	1.6
1 1/4"	31.8	155.4	77.7	1.6
1.5"	38.1	174.0	87.0	1.6
2.0"	50.8	212.4	106.2	1.6
2.5"	63.5	250.0	125.0	1.6
3.0"	76.2	288.4	144.2	1.6
4.0"	101.6	364.8	182.4	2.0

Short Cross AS ECS

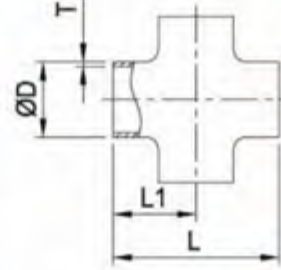

短四通

SIZE	φD	L	L1	T
1/2"	12.7	38.2	19.1	1.6
3/4"	19.1	57.2	28.6	1.6
1.0"	25.4	76.2	38.1	1.6
1 1/4"	31.8	95.4	47.7	1.6
1.5"	38.1	114.0	57.0	1.6
2.0"	50.8	152.4	76.2	1.6
2.5"	63.5	190.0	95.0	1.6
3.0"	76.2	228.4	114.2	1.6
4.0"	101.6	304.8	152.4	2.0

Reducing Tee & Equal Reducing Tee

AS RTL 变径三通

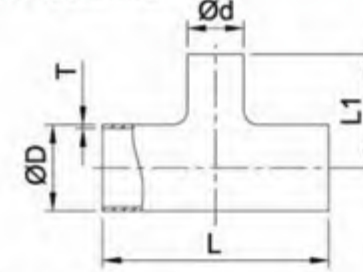

AS RTP 变径平口三通

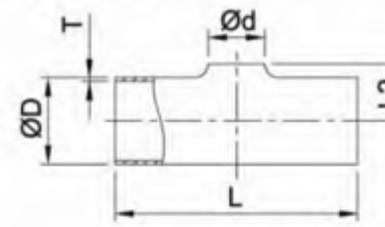

SIZE	φD	φd	L	L1	L2	T
1.5"x1.0"	38.1	25.4	160	80	22.05	1.6
2.0"x1.0"	50.8	25.4	160	80	28.4	1.6
2.0"x1.5"	50.8	38.1	160	80	28.4	1.6
2.5"x1.5"	63.5	38.1	160	80	34.75	1.6
2.5"x2.0"	63.5	50.8	160	80	34.75	1.6
3.0"x1.5"	76.2	38.1	160	80	41.1	1.6
3.0"x2.0"	76.2	50.8	160	80	41.1	1.6
3.0"x2.5"	76.2	63.5	190.5	95.3	41.1	1.6
4.0"x2.0"	101.6	50.8	160	80	53.8	2.0
4.0"x2.5"	101.6	63.5	190.5	95.3	53.8	2.0
4.0"x3.0"	101.6	76.2	114.3	114.3	53.8	2.0

AS CR 同心大小头
Concentric Reducer

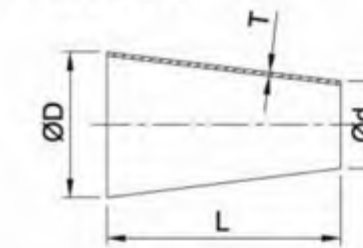

AS ER 偏心大小头
Eccentric Reducer

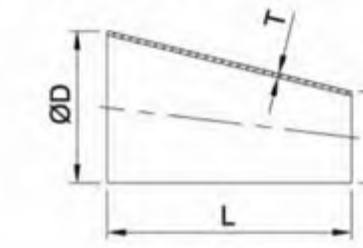

SIZE	φD	φd	L	T
3/4"x1/2"	19.1	12.7	19.1	1.6
1.0"x1/2"	25.4	12.7	25.4	1.6
1.0"x3/4"	25.4	19.1	25.4	1.6
1 1/4"x3/4"	31.8	19.1	31.8	1.6
1 1/4"x1.0"	31.8	25.4	31.8	1.6
1.5"x3/4"	38.1	19.1	38.1	1.6
1.5"x1.0"	38.1	25.4	38.1	1.6
1.5"x1 1/4"	38.1	31.8	38.1	1.6
2.0"x1/2"	50.8	12.7	50.8	1.6
2.0"x3/4"	50.8	19.1	50.8	1.6
2.0"x1.0"	50.8	25.4	50.8	1.6
2.0"x1 1/4"	50.8	31.8	50.8	1.6
2.0"x1.5"	50.8	38.1	50.8	1.6
2.5"x1.0"	63.5	25.4	63.5	1.6
2.5"x1 1/4"	63.5	31.8	63.5	1.6
2.5"x1.5"	63.5	38.1	63.5	1.6
2.5"x2.0"	63.5	50.8	63.5	1.6
3.0"x1/2"	76.2	12.7	76.2	1.6
3.0"x1 1/4"	76.2	31.8	76.2	1.6
3.0"x1.5"	76.2	38.1	76.2	1.6
3.0"x2.0"	76.2	50.8	76.2	1.6
3.0"x2.5"	76.2	63.5	76.2	1.6
4.0"x1.0"	101.6	25.4	101.6	1.6
4.0"x1 1/4"	101.6	31.8	101.6	1.6
4.0"x1.5"	101.6	38.1	101.6	1.6
4.0"x2.0"	101.6	50.8	101.6	1.6
4.0"x3.0"	101.6	76.2	101.6	1.6
5.0"x2.0"	127.0	50.8	127.0	1.6
5.0"x3.0"	127.0	76.2	127.0	1.6
5.0"x4.0"	127.0	101.6	127.0	1.6
6.0"x2.0"	152.4	50.8	152.4	1.6
6.0"x2.5"	152.4	63.5	152.4	1.6
6.0"x3.0"	152.4	76.2	152.4	1.6
6.0"x4.0"	152.4	101.6	152.4	1.6
6.0"x5.0"	152.4	127.0	152.4	1.6



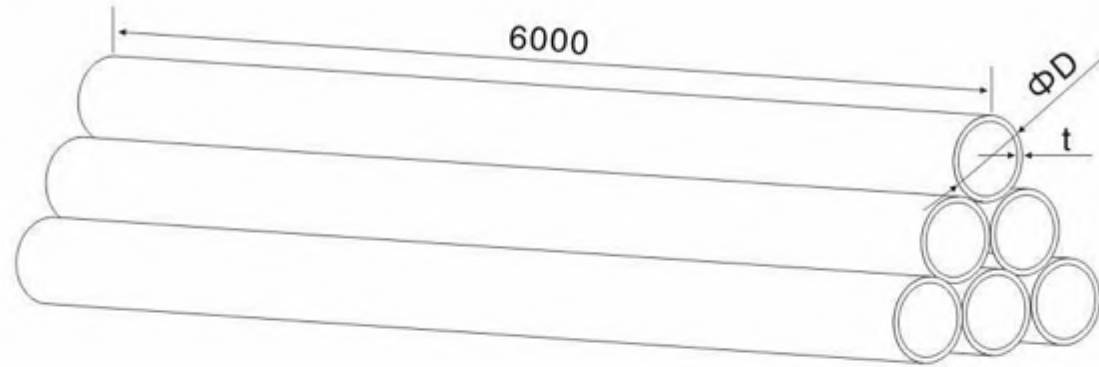

DIN		3A			SMS			
Size	D x t	D x t	Size	D	t	Size	D	t
DN10	12 x 1.5	13 x 1.5	1/2"	12.7	1.65	19	19.05	1.25/1.5
DN15	18 x 1.5	19 x 1.5	3/4"	19.05	1.65	25	25.4	1.25/1.5
DN20	22 x 1.5	23 x 1.5	1"	25.4	1.65	32	31.8	1.25/1.5
DN25	27 x 1.5	29 x 1.5	1 1/2"	38.14	1.65	38	38.1	1.25/1.5
DN32	34 x 1.5	35 x 1.5	2"	50.8	1.65	51	50.8	1.25/1.5
DN40	40 x 1.5	41 x 1.5	2 1/2"	63.5	1.65	63	63.5	1.6/2
DN50	52 x 1.5	53 x 1.5	3"	76.2	1.65	76	76.2	1.6/6
DN65	70 x 12	70 x 12	4"	101.6	2.1	89	88.9	2
DN80	85 x 2	85 x 2	6"	152.4	2.8	102	101.6	2
DN100	104 x 2	104 x 2	8"	203.2	2.8			
DN125	129 x 2	129 x 2						
DN150	154 x 2	154 x 2						
DN200	204 x 2	204 x 2						

